

Offering panoramic city views from the 33rd floor of the landmark Sheikh Rashid Tower, formerly known as The World Trade Centre, The World Trade Club is one of Dubai's most exclusive venues for business and social events. From high-level business meetings in our state-of-the-art Executive Boardroom, to business networking luncheons, cocktail gatherings and elaborate dinners, the Club offers an extensive celebrated menu and provides the perfect setting for all occasions.

With high speed connectivity, AV options, front office administration support, F&B services as well as complimentary valet parking, planning an event at The World Trade Club couldn't be easier.

SPACES

Room	Capacity						Size		
	Theatre with Screen	Round table 8 - 10 pax	Classroom with Screen	Boardroom	U-Shape	Cocktails	Dimensions (m)	Area (m ²)	Ceiling Height (m)
Falcon Lounge (Licensed Bar)	70	40	40	0	0	150	17.93 x 8.13	145.77	2.65
The World Trade Club Restaurant	160	100	70	50	80	200	17.93 x 9.73	174.46	2.65
Mogul Room	12	8	8 - 10	12	6	15	7.84 x 3.91	30.65	2.65
Pearl Room	30	10 - 12	12	12 - 14	12 - 18	30	8.40 x 5.92	66.53	2.65
Windsor Room	-	-	-	12 - 14	-	-	7.84 x 3.82	29.95	2.65
Majlis Room	55	40	25	30	25	30	7.84 x 7.9	62.25	2.65
Executive Boardroom	-	-	-	20	15	-	7.93 x 6.05	47.98	2.65
Club Room (Library)	30	40	10	10	8	25	5.92 x 7.85	46.47	2.65

THE WORLD TRADE CLUB

DUBAI

FLOOR PLAN

Falcon Lounge (Licensed Bar)	Mogul Room	Windsor Room	Executive Boardroom
The World Trade Club Restaurant	Pearl Room	Majlis Room	Club Room (Library)

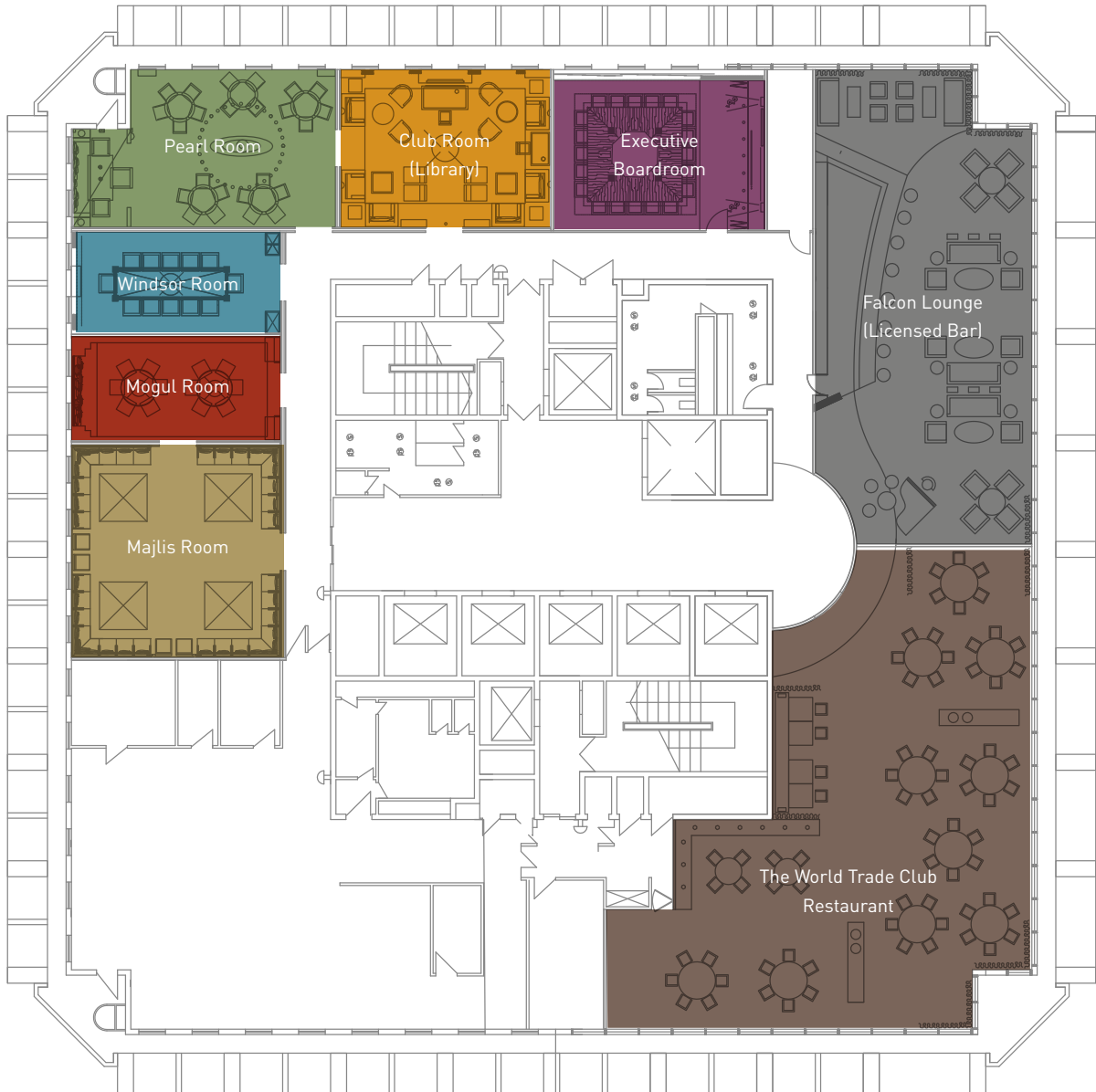

ACCESS

Located in the iconic Sheikh Rashid Tower on Level 33

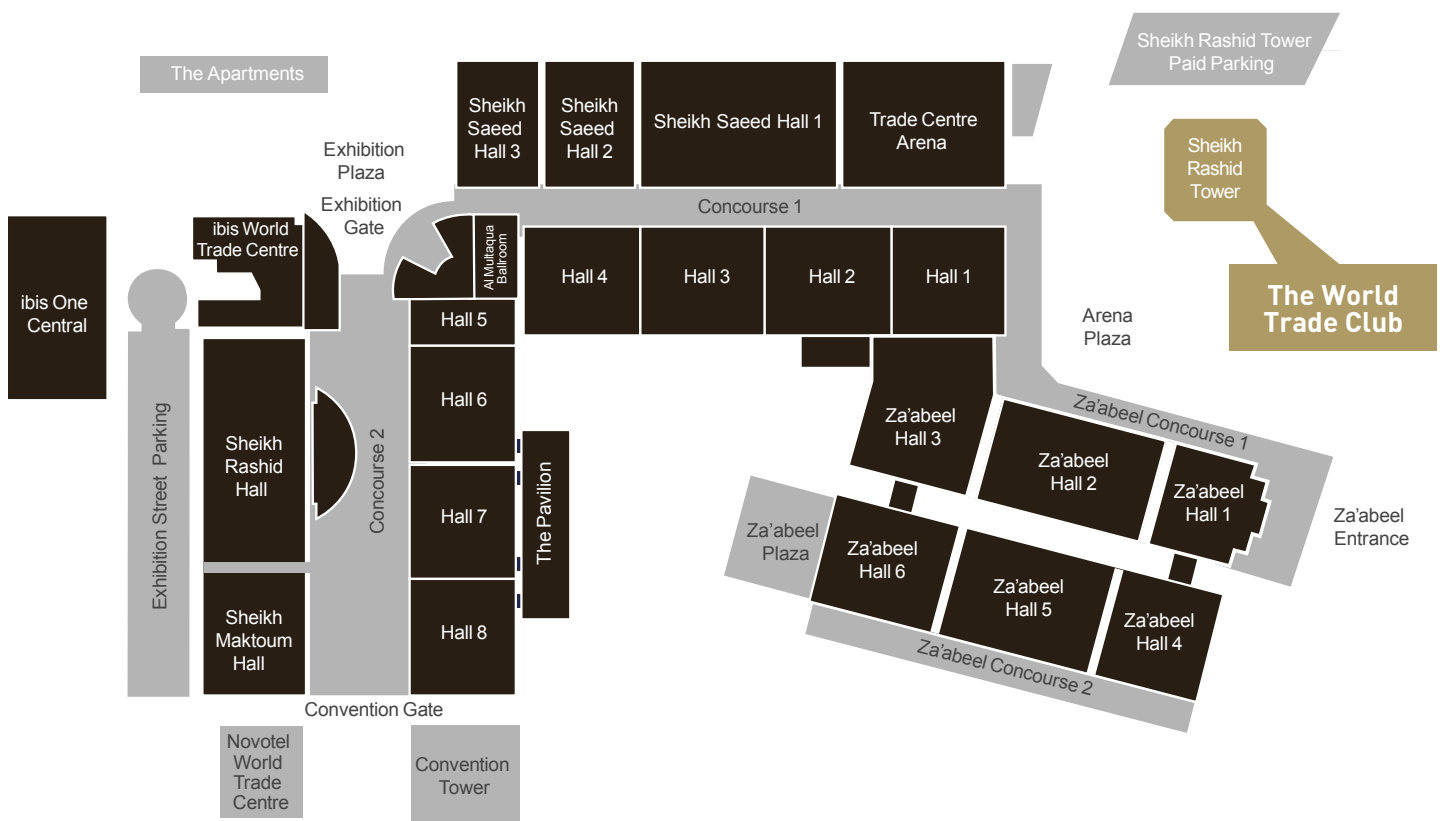

SPEAK TO US

For more information, contact our team between 9am and 10pm on

Email: wtc@dwtc.com | Tel: +971 (04) 309 7979